

Cash Acme™

V-3 Vacuum Breaker

The V-3 Vacuum Breaker prevents dangerous back-siphonage and backflow into a potable water supply. The V-3 is equipped with a protruding tip device for manual draining of a faucet (after hose removal), which prevents freezing. The V-3 is also available in a chrome-plated version (V-3C).

Note: These units are not intended for use where water contamination could occur as a result of draining or for permanent continuous pressure installation. For continuous pressure systems, install the BFP Dual Check Valve.

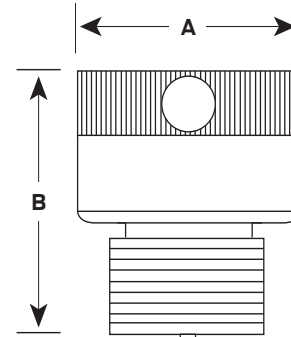

Specification Data

Performance	
Maximum Temperature	180°F (82.2 °C)
Maximum Pressure	125 psi
Service	Water

Materials		
1	Body	Brass
2	Seals	Buna-N
3	Springs	Stainless Steel

Dimensions (inches)						
Size	Connection Style	Part #	Lead Free	Finish	A	B
3/4"	NH Threaded w/ Locking Screw	17148-0000LF		Brass	1-5/16	1-5/16
3/4"	NH Threaded	17195-0000LF		Chrome	1-5/16	1-5/16
3/4"	NH Threaded w/ Locking Screw	17148-0000	Y	Brass	1-5/16	1-5/16
3/4"	NH Threaded	17195-0000	Y	Chrome	1-5/16	1-5/16

Certifications & Listings

ASSE 1011, CSA B.64.1.1, NSF/ANSI/CAN 61, NSF/ANSI/CAN 372



Refer to local plumbing code

Product Submittal	
Name	
Date	
Architect/Owner	
Contractor	
Tag	
Notes	

